

vtech®

User's Manual

Go! Go!
Smart Friends®

Enchanted Princess Palace™



© 2016 VTech
All rights reserved
Printed in China
91-003236-002 US

Dear Parent,

Welcome to the world of **Go! Go! Smart Friends**®! We're excited you've decided to go on an adventure with us and explore all that **Go! Go! Smart Friends**® has to offer. These toys have been designed to give your child a thrilling learning experience with hours of fun.

Go! Go! Smart Friends® features a collection of characters and playsets (each sold separately) that interact with your child by lighting up and playing fun responses. They introduce themselves, talk about their favorite things and more while encouraging first words and early vocabulary. But that's only the beginning of the learning excitement!

When your child interacts with our innovative **MagicPoint**® technology, they will love watching the characters and playsets come to life with motion, lights, music, and sounds as they play!

Additionally, our **Go! Go! Smart Friends**® playsets feature buttons, gears and other manipulative elements to encourage the development of your child's fine motor skills. Some playsets also have walkway track pieces that can be connected to other **Go! Go! Smart Friends**® playsets with walkway track pieces as well as **Go! Go! Smart Wheels**® and **Go! Go! Smart Animals**® playsets (each sold separately) to encourage creativity.

With **Go! Go! Smart Friends**®, it's playtime where friendship leads to learning™!

Sincerely,

Your friends at **VTech**®

To learn more about **VTech**® toys, visit vtechkids.com

INTRODUCTION

Thank you for purchasing the **VTech® Go! Go! Smart Friends® Enchanted Princess Palace™**.

This epic palace expands to more than four feet wide and has a variety of luxurious rooms, including a ballroom, music room, kitchen, parlor and observation tower. While exploring the palace with Princess Darla, place her on the five **MagicPoint®** locations to experience her friendly personality, lights and more. When Princess Darla sits at her **MagicChat™** tea set table with a friend (additional characters sold separately), they will chat and sing with each other.

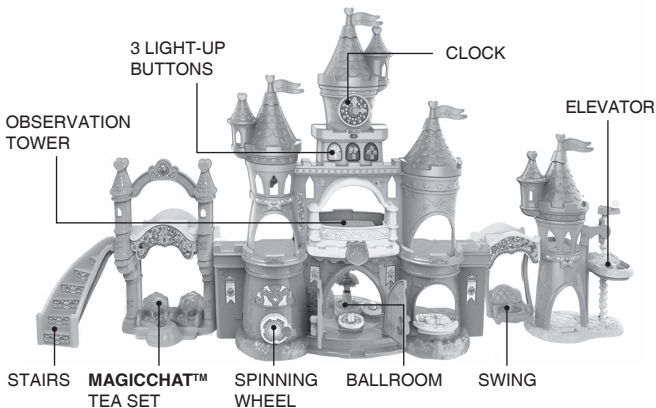

THREE ACCESSORIES



MAGICPOINT® CHARACTER

INCLUDED IN THIS PACKAGE

NOTE: This toy is not intended for teething.

- One **MagicPoint®** character
- Two pillars
- One observation tower railing

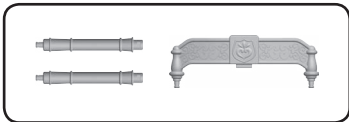

- One 1st floor main wall
- One 2nd floor main wall



- One 1st floor base and dance floor with one **MagicPoint®** location
- One 2nd floor base with one **MagicPoint®** location

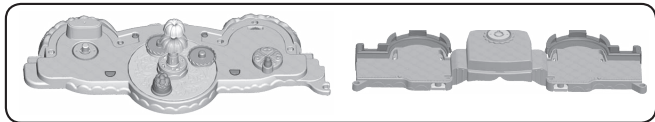

- One bed
- One harp
- One mirror



- One electronic clock tower
- Four flags
- One twin tower roof with toy engravings inside
- One twin tower roof with a smooth surface for label application
- One single tower roof

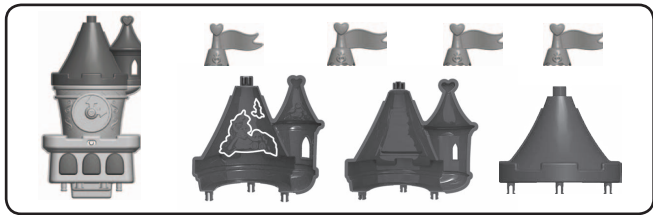

- Two piers
- One staircase
- One tower bridge
- One **MagicChat™** tea set with two **MagicPoint®** locations
- One tea set base

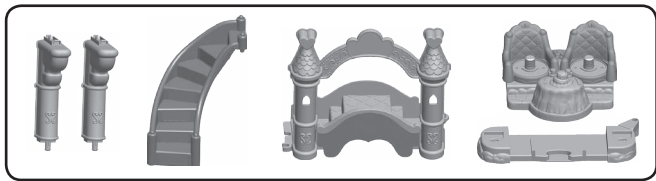

- One tower base
- One elevator platform
- One elevator tower support cover
- One tower with elevator support

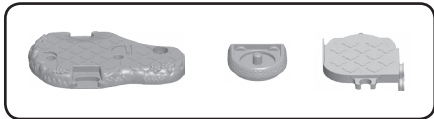

INCLUDED IN THIS PACKAGE

- Two swing ropes



- One swing seat



- One small bridge

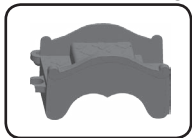

- Two doors
- One **MagicPoint®** support cover
- One chandelier support cover

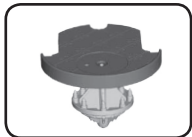
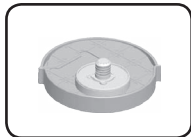

- Two label sheets

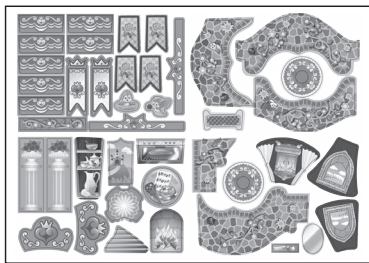

- One label instruction sheet
- User's manual

INCLUDED IN THIS PACKAGE

Unlock the packaging lock:

There is one packaging lock located on the character.

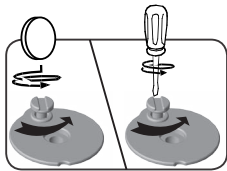

- ① Use a coin or screwdriver to loosen the screw.
- ② Pull out the screw with the packaging lock and discard them.

WARNING:

All packing materials, such as tape, plastic sheets, screws, packaging locks and tags are not part of this toy and should be discarded for your child's safety.

ATTENTION:

Pour la sécurité de votre enfant, débarrassez-vous de tous les produits d'emballage tels que rubans adhésifs, feuilles de plastique, vis, attaches et étiquettes. Ils ne font pas partie du jouet.

NOTE: Please keep this user's manual as it contains important information.

GETTING STARTED

BATTERY INSTALLATION - CHARACTER

1. Make sure the unit is **OFF**.
2. Locate the battery cover on the bottom of the unit. Use a screwdriver to loosen the screws.
3. Install 2 new AAA (LR03/AM-4) batteries following the diagram inside the battery box. (The use of new alkaline batteries is recommended for maximum performance.)

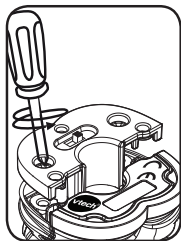

4. Replace the battery cover and tighten the screws to secure.

BATTERY INSTALLATION - ELECTRONIC CLOCK TOWER

1. Make sure the unit is **OFF**.
2. Locate the battery cover on the back of the clock tower. Use a screwdriver to loosen the screw.
3. Install 2 new AA (LR6/AM-3) batteries following the diagram inside the battery box. (The use of new alkaline batteries is recommended for maximum performance.)
4. Replace the battery cover and tighten the screw to secure.

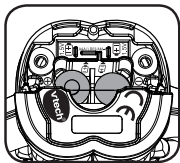

BATTERY NOTICE

- Use new alkaline batteries for maximum performance.
- Use only batteries of the same or equivalent type as recommended.
- Do not mix different types of batteries: alkaline, standard (carbon-zinc) or rechargeable (Ni-Cd, Ni-MH), or new and used batteries.
- Do not use damaged batteries.
- Insert batteries with the correct polarity.
- Do not short-circuit the battery terminals.
- Remove exhausted batteries from the toy.
- Remove batteries during long periods of non-use.
- Do not dispose of batteries in fire.
- Do not charge non-rechargeable batteries.
- Remove rechargeable batteries from the toy before charging (if removable).
- Rechargeable batteries are only to be charged under adult supervision.

ASSEMBLY INSTRUCTIONS

With the **VTech® Go! Go! Smart Friends® Enchanted Princess Palace™**, safety comes first. To ensure your child's safety, adult assembly is required.

- 1 Insert the two **PILLARS** into the **1ST FLOOR BASE** as shown in the picture. You will hear a “click” sound when the pieces are secure.



2. Insert the **1ST FLOOR MAIN WALL** into the **1ST FLOOR BASE** as shown in the picture. You will hear a “click” sound when the pieces are secure.

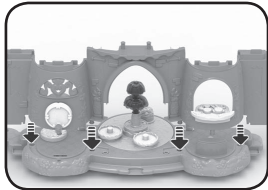

- 3 Attach the two **DOORS** to the **1ST FLOOR MAIN WALL** and **1ST FLOOR BASE** as shown in the picture.

Note: The door prongs are each a distinct shape. Carefully check the shape of each door prong and ensure you are inserting it into the correct hole.

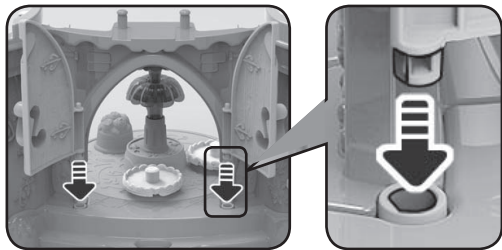

4. Insert the **OBSERVATION TOWER RAILING** into the **2ND FLOOR BASE**. Then, attach the **2ND FLOOR BASE** to the **1ST FLOOR MAIN WALL** as shown in the picture.

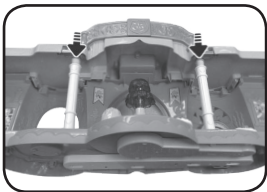
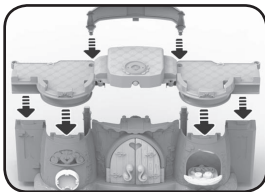

5. Insert the **2ND FLOOR MAIN WALL** into the **2ND FLOOR BASE** as shown in the picture.

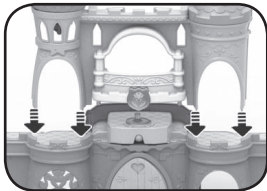

6. Insert the **ELECTRONIC CLOCK TOWER**, the **TWIN TOWER WITH TOY ENGRAVINGS** and the **SINGLE TOWER ROOF** into the **2ND FLOOR MAIN WALL** as shown in the picture. You will hear a “click” sound when the pieces are secure.

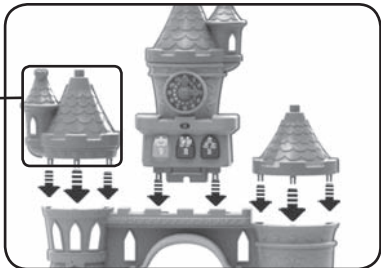

7. Attach three **FLAGS** to the **TOWERS** as shown in the picture.

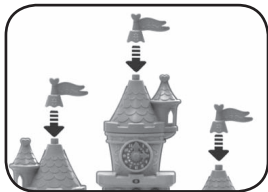

8. Insert the **MAGICPOINT® SUPPORT COVER** and **CHANDELIER SUPPORT COVER** into the **2ND FLOOR MAIN WALL** as shown in the picture.

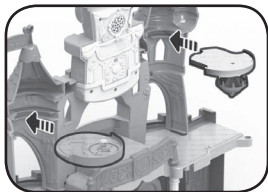

9. Now, assemble the left part of the palace following the below steps:
- Insert the two **PIERS** into the **TEA SET BASE**. You will hear a “click” sound when the pieces are secure.
 - Then, attach the **TOWER BRIDGE** to the **PIERS** as shown in the picture.
 - Then, attach the **MagicChat™ TEA SET** to the **TEA SET BASE**.
 - Finally, connect the **STAIRCASE** to the left side of the **TOWER BRIDGE** as shown in the picture.

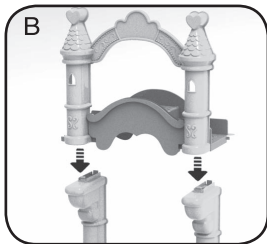
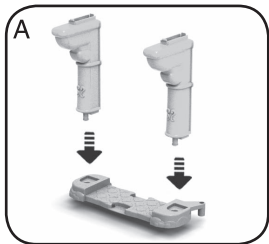

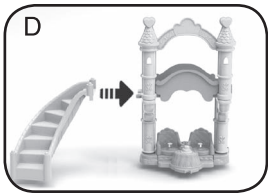
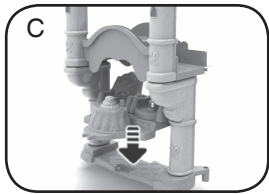

10. Follow the below steps to assemble the swing:

- A. Insert the two **SWING ROPES** into each side of the **SWING SEAT**.
- B. Then, attach the **SWING ROPES** to the bottom of the **SMALL BRIDGE** as shown in the picture.

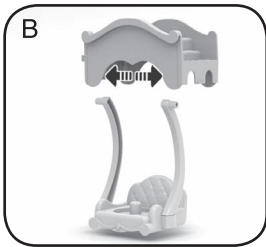
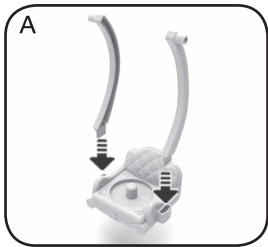

11. Now, assemble the right side of the palace:

- A. Insert the **ELEVATOR TOWER SUPPORT COVER** into the **TOWER WITH ELEVATOR SUPPORT**.
Then, insert the tower into the **TOWER BASE**. You will hear a “click” sound when the pieces are secure.
- B. Attach the **ELEVATOR PLATFORM** and **SWING** to the **TOWER WITH ELEVATOR SUPPORT**.
- C. Then, attach the remaining **TWIN TOWER ROOF** to the tower.
You will hear a “click” sound when the pieces are secure.
- D. Finally, attach a **FLAG** on the top of the roof.

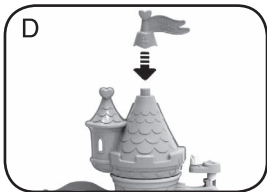
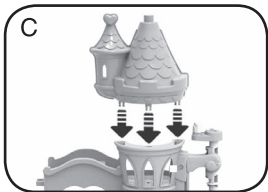
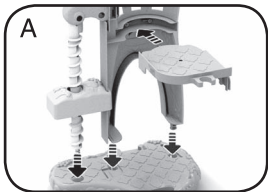

12. After the above steps, you can attach the left and right sections to the main palace.

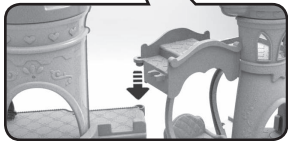
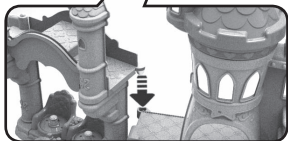
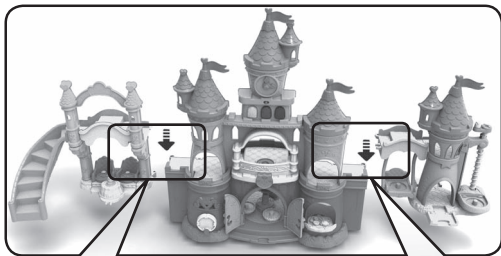

LABEL APPLICATION

Please adhere the labels to the playset securely as indicated on the **LABEL INSTRUCTION SHEET**.

PRODUCT FEATURES - CHARACTER

1. ON/OFF SWITCH

The **ON/OFF SWITCH** is located on the bottom of the character.

To turn the unit on, slide the **ON/OFF SWITCH** to the **ON** (⏻) position. To turn the unit off, slide the **ON/OFF SWITCH** to the **OFF** (●) position.

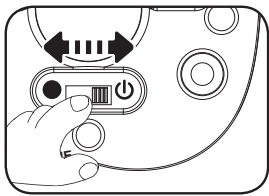

2. AUTOMATIC SHUT-OFF

To preserve battery life, the **VTech® Go! Go! Smart Friends®** character will automatically power down after several minutes of no input. The unit can only be turned on again by pressing the **LIGHT-UP BUTTON** or placing it on a **MagicPoint®** location.

The **LIGHT-UP BUTTON** will flash several times when the unit's battery level is low. When this happens, please install new batteries.

PRODUCT FEATURES - ELECTRONIC CLOCK TOWER

1. OFF/MODE SELECTOR

To turn the palace on, slide the selector from **OFF** to either the **Learning Fun Mode** or **Music Mode**. To turn the palace off, slide the selector to the **OFF** position.

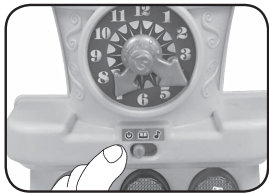

2. LIGHT-UP BUTTONS

Press the three **LIGHT-UP BUTTONS** to learn about colors and objects and to hear fun sounds and sing-along songs.



3. CLOCK HANDS

Turn the **CLOCK HANDS** to trigger fun phrases, sounds and melodies.

Note: If the palace powers down while playing, we suggest replacing the batteries.



ACTIVITIES – CHARACTER

1. Slide the **ON/OFF SWITCH** to turn the unit **ON**. Then, press the **LIGHT-UP BUTTON** to hear phrases, songs, melodies and fun sounds.
2. Place the character on one of the playset's five **MagicPoint**[®] locations to hear phrases, fun sounds, short tunes and sing-along songs. Some of the **MagicPoint**[®] locations can even turn on the playset's lights. The character can also interact with other **VTech**[®] **Go! Go! Smart Friends**[®] playsets (each sold separately).

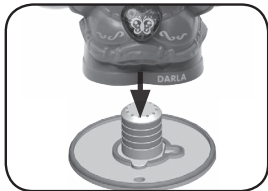

ACTIVITIES – ELECTRONIC CLOCK TOWER

Mode 1: Learning Fun

Slide the **OFF/MODE SELECTOR** to the middle position to enter this mode. Press the **LIGHT-UP BUTTONS** to learn colors, objects, letters, counting and more! Turn the **CLOCK HANDS** to hear fun phrases that encourage imaginative play.



Mode 2: Music

Slide the **OFF/MODE SELECTOR** to the third position to enter this mode. Press the **LIGHT-UP BUTTONS** or turn the **CLOCK HANDS** to hear some melodies and songs.



ACTIVITIES – ENCHANTED PRINCESS PALACE™

1. Place the character on the **DRESSING ROOM MagicPoint®** location to pretend she is looking into the mirror.

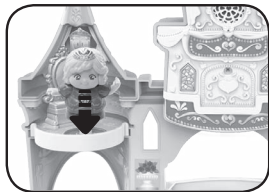

2. Place the character on the **OBSERVATION TOWER MagicPoint®** located in the center of the palace to light up the palace's light and to let the character enjoy the view.



3. Place the character on the **KITCHEN MagicPoint®** location to pretend she is preparing a meal for her kingdom friends!



4. There are two **MagicPoint®** locations on the **MagicChat™ TEA SET**:

- a. Place the character on the **MagicPoint®** located on the chair as shown in the picture to turn on the table's light and to let the character rest as she has some tea.
- b. Place the character on the **MagicPoint®** located on the other chair as shown in the picture to hear fun responses.



MagicChat™

If you have an additional **Go! Go! Smart Friends® MagicPoint®** character, place one character on each of the **MagicPoint®** locations on the **TEA SET** to activate the **MagicChat™** feature. You can hear the characters talk and sing together. (Additional character not included. Each sold separately.)

Motor Skills Development

There are lots of fun things in the **Enchanted Princess Palace™** that you can explore to help develop fine motor skills.

1. Turn the **SPINNING WHEEL** to open and close the palace gates.

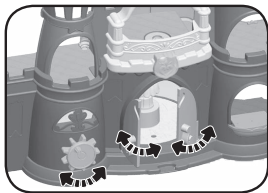

2. Spin the **CHANDELIER**.

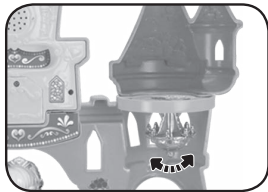

3. Turn the handle in the parlor to spin the **DANCE FLOOR**. The water in the fountain will also move up and down!

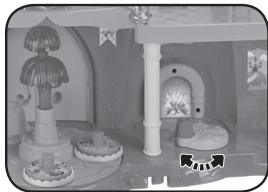

4. Place the character on the **SWING** and push it to help her swing!



5. Place the character on the **ELEVATOR** and turn the knob on the top to move the elevator up and down.



6. Three **ACCESSORIES** are included for role-play fun.



7. Place the **MagicChat™ TEA SET** accessory around the palace for role-play fun.



- The palace can be folded for easy storage. Fold in the left and right sides as shown below. When folding in the sides, be sure to insert the prongs on each side of the palace into their respective slots located on the edge of the second floor.

Note: You need to remove or fold back the staircase to be able to completely close the palace.

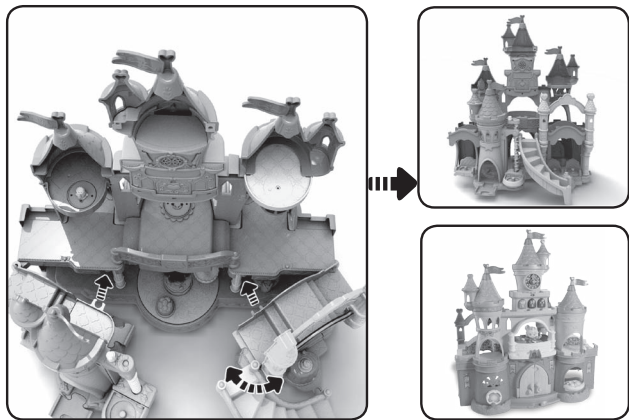

CARE & MAINTENANCE

- Keep the unit and its metal parts clean by wiping them with a slightly damp cloth.
- Keep the unit out of direct sunlight and away from any direct heat sources.
- Remove the batteries when the unit is not in use for an extended period of time.
- Do not drop the unit on a hard surface and do not expose the unit to excess moisture or water.

TROUBLESHOOTING

If for some reason the unit stops working or malfunctions while playing with a **MagicPoint**[®] accessory, please remove the character from the accessory and place the character back onto the **MagicPoint**[®].

If the unit still does not function, or if for some reason the unit stops working or malfunctions on its own, please follow these steps:

1. Please turn the unit **OFF**.
2. Interrupt the power supply by removing the batteries.
3. Let the unit stand for a few minutes, then replace the batteries.
4. Turn the unit **ON**. The unit should now be ready to play again.
5. If the product still does not work, replace with a new set of batteries.

If the problem persists, please call our Consumer Services Department at 1-800-521-2010 in the U.S. or 1-877-352-8697 in Canada, or go to our website at www.vtechkids.com and fill out our Contact Us form located under the Customer Support link. A service representative will be happy to help you.

IMPORTANT NOTE:

Creating and developing **VTech**[®] products is accompanied by a responsibility that we at **VTech**[®] take very seriously. We make every effort to ensure the accuracy of the information, which forms the value of our products. However, errors sometimes can occur. It is important for you to know that we stand behind our products and encourage you to call our Consumer Services Department at 1-800-521-2010 in the U.S. or 1-877-352-8697 in Canada, or go to our website at www.vtechkids.com and fill out our Contact Us form located under the Customer Support link with any problems and/or suggestions that you might have. A service representative will be happy to help you.

Note: This equipment has been tested and found to comply with the limits for a Class B digital device, pursuant to Part 15 of the FCC Rules. These limits are designed to provide reasonable protection against harmful interference in a residential installation. This equipment

generates, uses and can radiate radio frequency energy and, if not installed and used in accordance with the instructions, may cause harmful interference to radio communications. However, there is no guarantee that interference will not occur in a particular installation. If this equipment does cause harmful interference to radio or television reception, which can be determined by turning the equipment off and on, the user is encouraged to try to correct the interference by one or more of the following measures:

- Reorient or relocate the receiving antenna.
- Increase the separation between the equipment and receiver.
- Connect the equipment into an outlet on a circuit different from that to which the receiver is connected.
- Consult the dealer or an experienced radio/TV technician for help.

Caution: Changes or modifications not expressly approved by the party responsible for compliance could void the user's authority to operate the equipment.

THIS DEVICE COMPLIES WITH PART 15 OF THE FCC RULES. OPERATION IS SUBJECT TO THE FOLLOWING TWO CONDITIONS:

(1) THIS DEVICE MAY NOT CAUSE HARMFUL INTERFERENCE, AND (2) THIS DEVICE MUST ACCEPT ANY INTERFERENCE RECEIVED, INCLUDING INTERFERENCE THAT MAY CAUSE UNDESIRE OPERATION.

CAN ICES-3 (B)/NMB-3(B)

CLASS 1
LED PRODUCT



PRODUCT WARRANTY

This Warranty is applicable only to the original purchaser, is non-transferable and applies only to "VTech" products or parts. This product is covered by a 3-month Warranty from the original purchase date, under normal use and service, against defective workmanship and materials. This Warranty does not apply to (a) consumable parts, such as batteries; (b) cosmetic damage, including but not limited to scratches and dents; (c) damage caused by use with non-VTech products; (d) damage caused by accident, misuse, unreasonable use, immersion in water, neglect, abuse, battery leakage, or improper installation, improper service, or other external causes; (e) damage caused by operating the product outside the permitted or intended uses described by VTech in the owner's manual; (f) a product or part that has been modified (g) defects caused by normal wear and tear or otherwise due to the normal aging of the product; or (h) if any VTech serial number has been removed or defaced.

Prior to returning a product for any reason, please notify the VTech Consumer Services Department by going to our website at www.vtechkids.com, filling out our Contact Us form located under the Customer Support link or calling 1-800-521-2010.

If the service representative is unable to resolve the issue, you will be provided instructions on how to return the product and have it replaced under Warranty. Return of the product under Warranty must adhere to the following rules: If VTech believes that there may be a defect in the materials or workmanship of the product and can confirm the purchase date and location of the product, we will at our discretion replace the product with a new unit or product of comparable value. A replacement product or parts assumes the remaining Warranty of the original product or 30 days from the date of replacement, whichever provides longer coverage.

THIS WARRANTY AND THE REMEDIES SET FORTH ABOVE ARE EXCLUSIVE AND IN LIEU OF ALL OTHER WARRANTIES, REMEDIES AND CONDITIONS, WHETHER ORAL, WRITTEN, STATUTORY, EXPRESS OR IMPLIED. IF VTECH CANNOT LAWFULLY DISCLAIM STATUTORY OR IMPLIED WARRANTIES THEN TO THE EXTENT PERMITTED BY LAW, ALL SUCH WARRANTIES SHALL BE LIMITED TO THE DURATION OF THE EXPRESS WARRANTY AND TO THE REPLACEMENT SERVICE AS DETERMINED BY VTECH IN ITS SOLE DISCRETION.

To the extent permitted by law, VTech will not be responsible for direct, special, incidental or consequential damages resulting from any breach of Warranty.

This Warranty is not intended to persons or entities outside the United States of America. Any disputes resulting from this Warranty shall be subject to the final and conclusive determination of VTech.